

TYPICAL NOTE: ALL EXISTING LINE SETS AND ELECTRICAL LINES / CONNECTIONS (AS OCCUR) ARE TO BE REPLACED WITH NEW - WITH THE EXCEPTION OF RIGHT AT THE EQUIPMENT LOCATION, ELECTRICAL LINES AND JUNCTION BOX'S THAT ARE RUN ABOVE THE ROOF, AND OR DECK, ARE TO BE REPLACED AND RE-RUN BENEATH THE DECK BACK TO THE NEAREST JUNCTION OR ELECTRICAL BOX - NO FLEXIBLE ELECTRICAL CONDUIT WILL BE ALLOWED LOWER THAN 12" ABOVE THE FINISHED ROOF SURFACE - ALL ELECTRICAL WORK MUST BE DONE TO NEC STANDARDS

ROOFTOP EQUIPMENT VARIES - IF EQUIPMENT MOUNTING POINTS ALIGN WITH THE CHANNEL FRAME, ATTACHMENT OF EQUIPMENT CAN BE MADE DIRECTLY TO THE FRAME - IF EQUIPMENT MOUNTING POINTS DO NOT ALIGN WITH THE CHANNEL FRAME, MOUNT TO A UNI-STRUT SYSTEM THAT WOULD SPAN BETWEEN AND ATTACH TO BOTH THE CHANNEL FRAME AS WELL AS THE EQUIPMENT MOUNTS

FIELD CUT BOTTOM OF SUPPORT POSTS AS REQ'D. TO ACHIEVE A LEVEL PLATFORM

NOTE THAT THIS DETAIL IS TO BE USED WHEREVER ROOFTOP EQUIPMENT WOULD TYPICALLY BE INSTALLED ON WOOD, BOXED, CURB - WOOD CURBS SHOULD NOT BE USED

COORDINATE WITH DETAIL #03 AND DETAIL #04 FOR ELECTRICAL AND OR LINE SET (AS OCCURS) PENETRATION DETAILS

NOTE THAT WALK PADS ARE TO BE PROVIDED AT ALL 4 SIDES OF THESE ELEVATED PLATFORMS

ROTATE DIRECTION OF BASE PLATES AS REQ'D TO ALIGN WITH SLOPE OF DECK (TYP.)

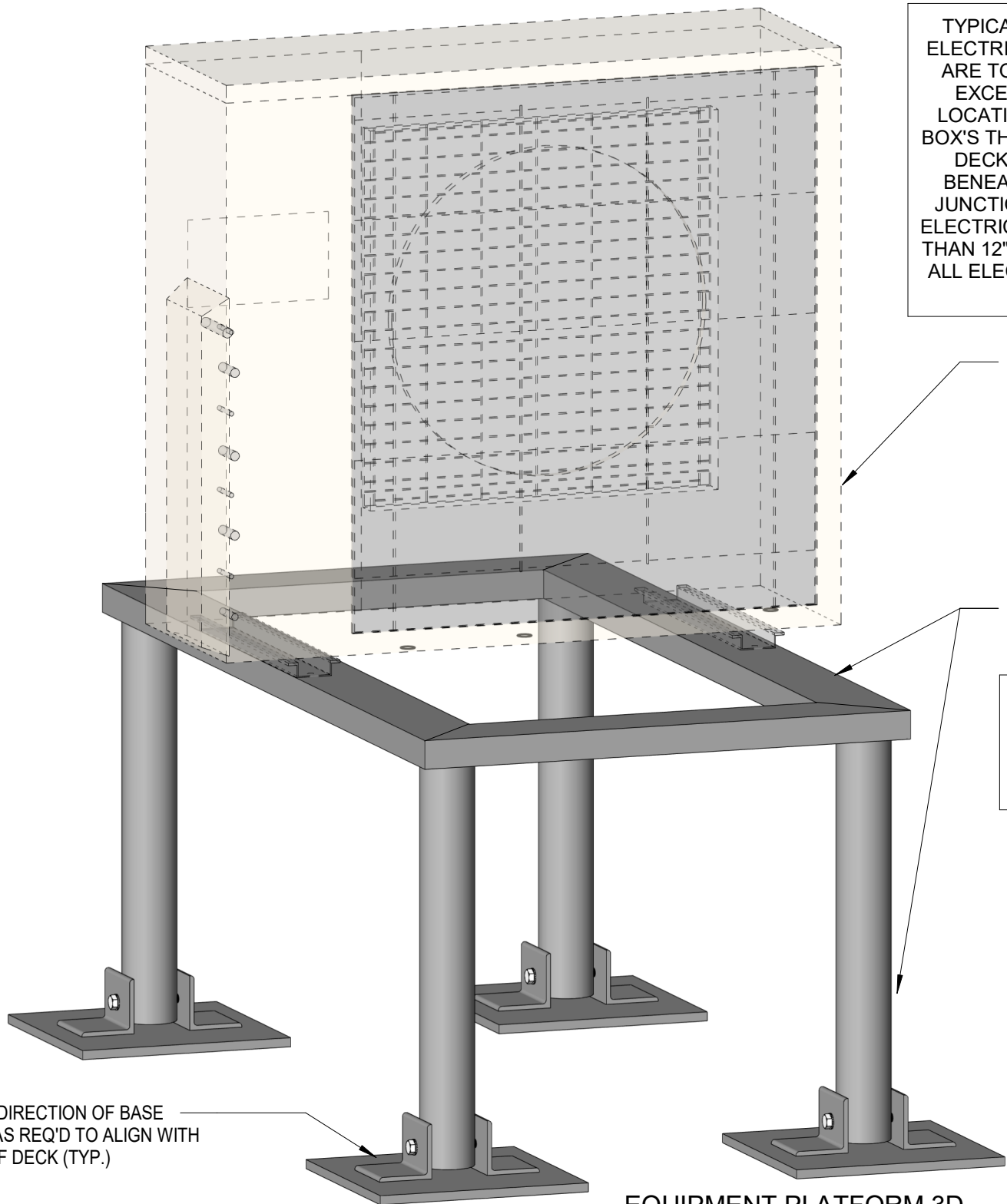

EQUIPMENT PLATFORM 3D

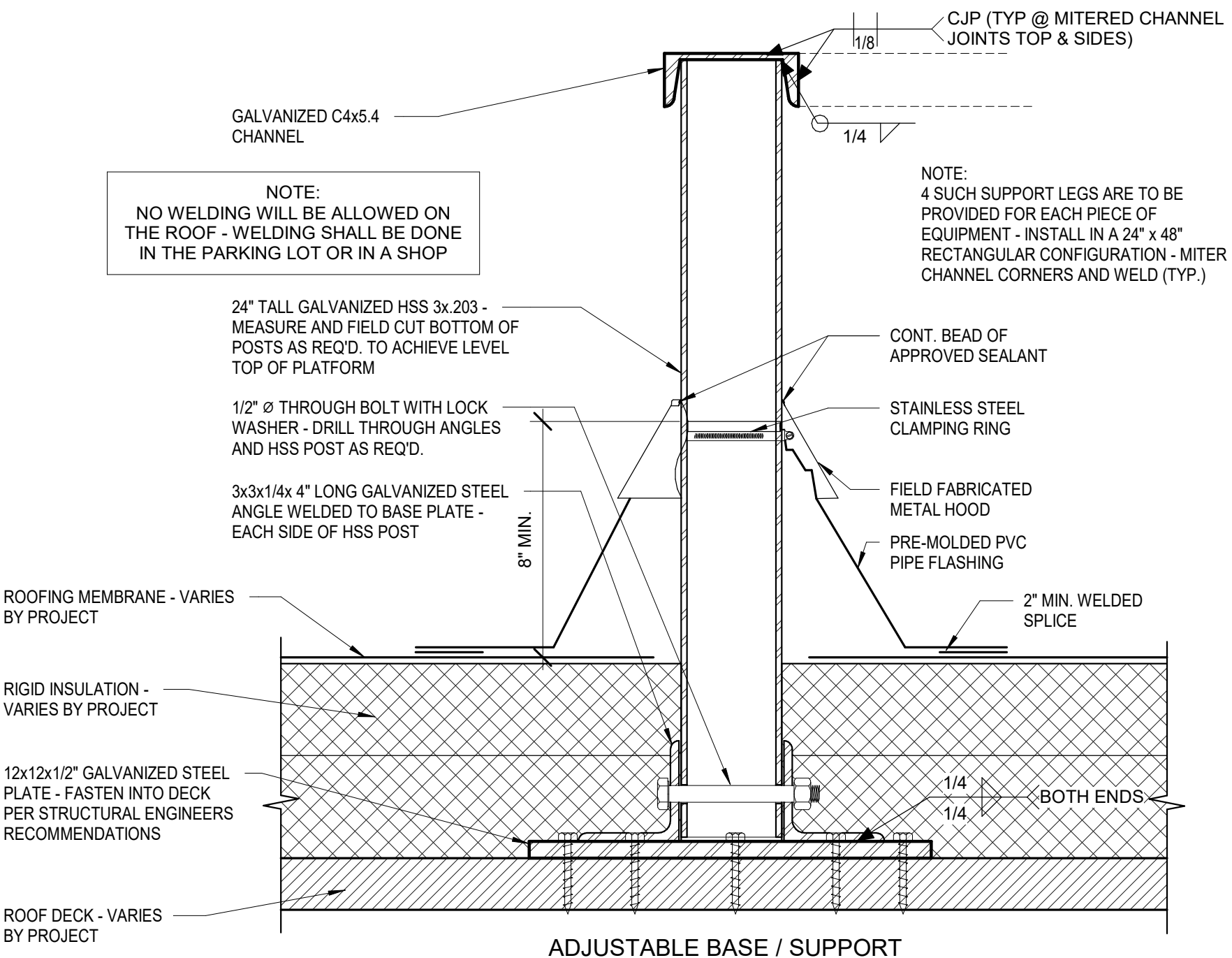

NOTE:  
NO WELDING WILL BE ALLOWED ON THE ROOF - WELDING SHALL BE DONE IN THE PARKING LOT OR IN A SHOP

NOTE:  
4 SUCH SUPPORT LEGS ARE TO BE PROVIDED FOR EACH PIECE OF EQUIPMENT - INSTALL IN A 24" x 48" RECTANGULAR CONFIGURATION - MITER CHANNEL CORNERS AND WELD (TYP.)

ADJUSTABLE BASE / SUPPORT